

MAV2005 Locking Assembly - for imperial shaft

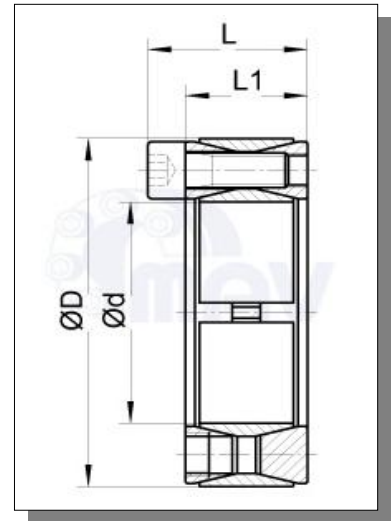

Characteristics:

- not self centering
- not self locking
- compact design (low volume)
- screws UNI 5931 (DIN912)



Example of order: MAV2005 47,63 x 85 (d x D)

dimensions						screws		transmissible torque Mt Nm	transmissible axial load Fax kN	contact pressure on shaft Ps N/mm ²	contact pressure in hub Ph N/mm ²
d x D mm	d inch	d mm	D mm	L1 mm	L mm	size	Ma Nm				
19,05 x 47	3/4	19,05	47	20	26	M 6	17	310	33	314	127
22,23 x 47	7/8	22,23	47	20	26	M 6	17	360	33	269	127
25,40 x 50	1	25,40	50	20	26	M 6	17	460	36	264	134
28,58 x 55	1 1/8	28,58	55	20	26	M 6	17	570	40	261	136
30,16 x 54,84	1 3/16	30,16	54,84	20	26	M 6	17	600	40	247	136
31,75 x 60	1 1/4	31,75	60	20	26	M 6	17	760	48	282	149
34,93 x 60,07	1 3/8	34,93	60,07	20	26	M 6	17	830	48	256	149
36,51 x 65	1 7/16	36,51	65	20	26	M 6	17	1010	55	286	161
38,10 x 65	1 1/2	38,10	65	20	26	M 6	17	1050	55	274	161
41,28 x 75	1 5/8	41,28	75	24	32	M 8	41	1800	87	342	188
42,86 x 75	1 11/16	42,86	75	24	32	M 8	41	1870	87	329	188
44,45 x 75	1 3/4	44,45	75	24	32	M 8	41	1930	87	318	188
47,63 x 80	1 7/8	47,63	80	24	32	M 8	41	2060	87	296	176
49,21 x 80	1 15/16	49,21	80	24	32	M 8	41	2130	86	287	176
50,80 x 85	2	50,80	85	24	32	M 8	41	2550	101	324	194
53,98 x 85	2 1/8	53,98	85	24	32	M 8	41	2700	100	305	194
55,56 x 90	2 3/16	55,56	90	24	32	M 8	41	2780	100	296	183
57,15 x 90	2 1/4	57,15	90	24	32	M 8	41	2850	100	288	183
60,33 x 89,69	2 3/8	60,33	89,69	24	32	M 8	41	3000	100	273	184
61,91 x 95	2 7/16	61,91	95	24	32	M 8	41	3510	114	304	198
63,50 x 95	2 1/2	63,50	95	24	32	M 8	41	3600	113	296	198
65,09 x 94,92	2 9/16	65,09	94,92	24	32	M 8	41	3680	113	289	198
66,68 x 110	2 5/8	66,68	110	28	38	M 10	83	5400	162	337	204
68,26 x 110	2 11/16	68,26	110	28	38	M 10	83	5520	162	329	204
69,85 x 110,16	2 3/4	69,85	110,16	28	38	M 10	83	5640	162	322	204
73,03 x 115	2 7/8	73,03	115	28	38	M 10	83	5880	161	308	196
74,61 x 115	2 15/16	74,61	115	28	38	M 10	83	6000	161	301	196
76,20 x 120	3	76,20	120	28	38	M 10	83	6120	161	295	187
79,38 x 120	3 1/8	79,38	120	28	38	M 10	83	6360	160	283	187
82,55 x 125	3 1/4	82,55	125	28	38	M 10	83	7540	183	311	206
85,73 x 125	3 3/8	85,73	125	28	38	M 10	83	7810	182	300	206
87,31 x 130	3 7/16	87,31	130	28	38	M 10	83	7950	182	294	198
88,90 x 130	3 1/2	88,90	130	28	38	M 10	83	8080	182	289	198
95,25 x 134,75	3 3/4	95,25	134,75	28	38	M 10	83	9700	204	304	215
98,43 x 145	3 7/8	98,43	145	33	45	M 12	145	11500	234	312	212
100,01 x 145	3 15/16	100,01	145	33	45	M 12	145	11700	234	307	212
101,60 x 148,41	4	101,60	148,41	33	45	M 12	145	11900	234	303	207
106,38 x 155	4 3/16	106,38	155	33	45	M 12	145	12400	233	289	198
112,71 x 165	4 7/16	112,71	165	33	45	M 12	145	14900	265	312	213
114,30 x 165	4 1/2	114,30	165	33	45	M 12	145	15100	265	307	213

MAV2005 Locking Assembly - for imperial shaft



Characteristics:

- not self centering
- not self locking
- compact design (low volume)
- screws UNI 5931 (DIN912)

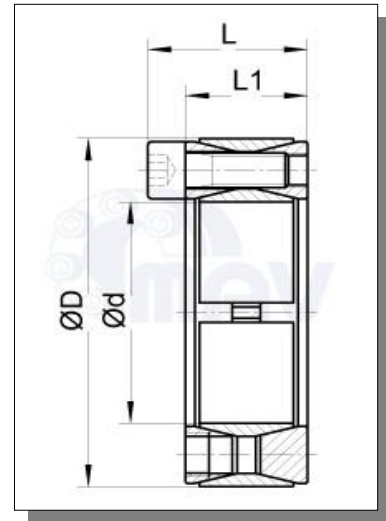

Example of order: MAV2005 47,63 x 85 (d x D)

dimensions						SCREWS		transmissible torque Mt Nm	transmissible axial load Fax kN	contact pressure on shaft Ps N/mm ²	contact pressure in hub Ph N/mm ²
d x D mm	d inch	d mm	D mm	L1 mm	L mm	size	Ma Nm				
125,41 x 180	4 15/16	125,41	180	38	50	M 12	145	20700	329	268	187
127,00 x 180	5	127,00	180	38	50	M 12	145	20900	329	264	187
138,11 x 190	5 7/16	138,11	190	38	50	M 12	145	24900	360	267	194
139,70 x 190,30	5 1/2	139,70	190,30	38	50	M 12	145	25100	360	264	194
152,40 x 210	6	152,40	210	38	50	M 12	145	32200	423	286	208
163,51 x 225	6 7/16	163,51	225	44	58	M 14	230	39700	486	276	200
165,10 x 225	6 1/2	165,10	225	44	58	M 14	230	40100	486	273	200
176,21 x 235	6 15/16	176,21	235	44	58	M 14	230	46500	528	279	209
177,80 x 235	7	177,80	235	44	58	M 14	230	46900	527	277	209
190,50 x 249,50	7 1/2	190,50	249,50	52	66	M 14	230	58400	613	249	190
200,00 x 260	7 7/8	200,00	260	52	66	M 14	230	65400	655	254	195
203,20 x 266,80	8	203,20	266,80	52	66	M 14	230	66400	654	250	190

Information subject to change without prior notification



We are specialized in customized solutions.
All Locking Devices are available in different dimensions and materials. Please contact us for detailed information.